



Key Industries:

- Material handling
- Food & Beverage
- Pulp & Paper
- Waste water
- Packaging
- Paint and coating lines

Features:

- Available in 4 sizes
- Torque ranges from 6Nm to 500Nm
- Shaft sizes up to 50.8 mm (2 inches)

Benefits:

- Low cost
- Reliable protection
- Simple operation

Rexnord Autogard 100 Series Torque Limiter

Improve your operation's efficiency and profitability

The Rexnord® Autogard® 100 Series Torque Limiter is a general purpose torque overload device that provides low cost, reliable protection for industrial equipment.

It features a mechanism that will reliably disconnect a mechanical drive when a pre-set torque level is exceeded and then automatically reset in the same position after the cause of the overload is resolved.

Disconnection due to torque overload can be signalled by using a proximity sensor.

Rexnord Autogard 100 Series Torque Limiters are offered in two configurations, model 103 and model 106. Model 103 is for use on chain and belt drives with the addition of a sprocket or a pulley. Model 106 is for shaft-to-shaft applications and includes a standard flexible jaw coupling.

Model 106



Model 103*



* Model 103 shown with duplex sprocket fitted.

Model 103

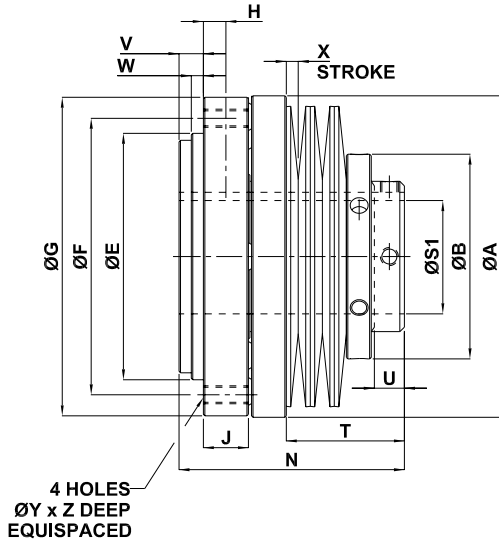

Model 106

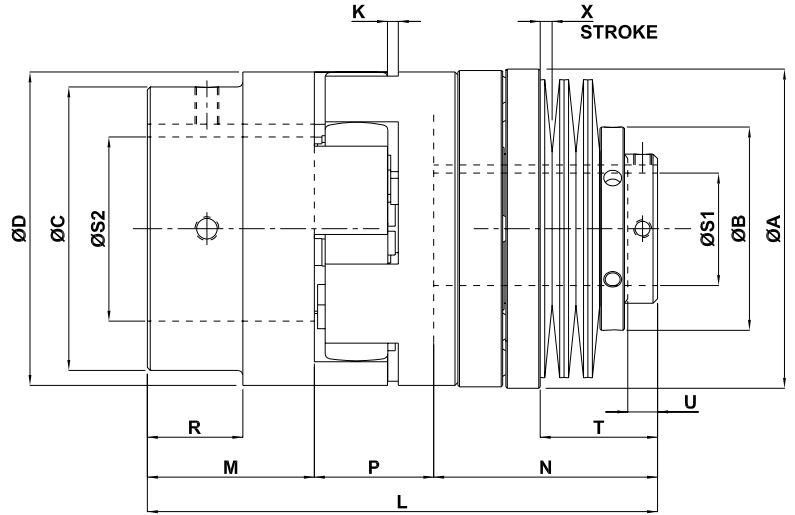

Size	Torque range 1	Torque range 2	Torque range 3	Max. speed	Model 103		Model 106	
					Mass ①	Inertia ①	Mass ①	Inertia ①
					Nm	Nm	Nm	rpm
1	6-14	14-25	25-60	500	0.53	0.00018	1.50	0.00093
2	12.5-30	30-50	50-100	500	1.25	0.00075	3.86	0.0049
3	25-60	60-100	100-250	500	2.42	0.0023	6.40	0.0097
4	50-120	100-200	200-500	300	3.88	0.0055	11.55	0.028

① Mass and inertia values are for torque limiters with maximum bore sizes

Size	S1 ②	S2 ②	A	B	C	D	E ③	F	G ④	H ⑤	J	K	L	M	N	P DBSE		R	T	U ⑥	V	W	X	Y	Z
	Bore Max	Bore Max	mm	mm	mm	mm	mm	mm	mm	mm	mm	mm	mm	mm	mm	mm	mm	mm	mm	mm	mm	mm	mm	mm	mm
	1	20	40	62	40	65	65	50	56	61	7	13.5	2.5	112	35	48	29	-	25.4	6	4.1	2	1.5	M4	8
2	25.4	55	86	52	85	95	65	75	85	6.3	14.5	3	147	50	61	36	28	32.6	6	7.5	3	2	M6	11	
3	38.1	62	107	68	95	105	82	92	106	8.5	19	3.5	171	56	75	40	32	39.3	10	8.1	4	2	M6	15	
4	50.8	80	131	86	115	135	100	114	130	8	20.5	4.5	210	75	87	48	47	50.5	12	8.7	4	2.2	M8	16	

② Unless otherwise specified, bores will be manufactured with H7 tolerances and keyways will be normal fit as per BS-4235-1. Shallow keyways may be required for near max. bore sizes.

③ h7 toleranced fit

④ h7 tolerance for drive media location

⑤ Dimension to centre-line of drive plate bearing

⑥ Length may be shortened by dimension U if set screws are not required

Size	Smallest ISO 606 Sprocket (No. of Teeth)			
	3/8" pitch	1/2" pitch	5/8" pitch	3/4" pitch
1	26	21	17	-
2	34	26	21	-
3	-	32	26	22
4	-	38	31	26

The specifications contained herein are under continuous review and are subject to change.