



Please contact your Rexnord Representative with any questions:

Rexnord FlatTop Europe
Einsteinstraat 1, 2691 GV
's-Gravenzande
The Netherlands
Phone: +31 174 445 111

Rexnord FlatTop Italy
Phone: +39 0522 639333

www.rexnord.com

TableTop Chain Assembly Tools

For safe and easy operation

Rexnord FlatTop continuously develops and introduces new products for conveyors. To make sure that our chains can be easily and safely installed, Rexnord also developed chain assembly tools.

Complete line of TableTop assembly tools

Rexnord now offers a wide range of TableTop® chain assembly tools, suitable for most common 1.5" TableTop chains (plastic and metal), heavy-duty and double-hinge metal TableTop chains and the Rexnord 661 Series Metal TableTop chain.

Safe operation

The TableTop Chain Assembly Tool helps improve safety conditions during chain assembly and disassembly. The tool aligns the chains, and using a classic hammer and punch, chain pins can be removed and installed in a safe manner.

Easy to use

The assembly tools align the two strands of chain prior to connecting the sections with the pin. The chain remains in this position, making it easier for the operator to connect the chain.

Rexnord Chain Assembly Tool Sets consist of the following:

- Machined quality block
- Punch
- User manual



Rexnord Chain Assembly Tool Set for Rexnord 661 Series TableTop Chain

Plastic & Metal TableTop Chain 1.5" Pitch

Features a machined quality block made out of impact-resistant Polyamid Material for safe and easy operation; suitable for most common 1.5" TableTop Chain executions.

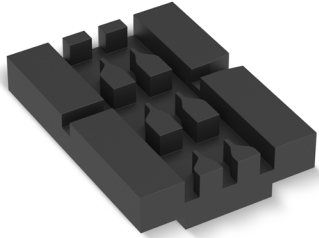

Suitable for the following chains:

Plastic TableTop Chain:

- xx820-2.5IN up to xx820-7.5IN
- xx831-3.25IN up to xxx831-7.5IN
- xx_SHP-xx
- xx_RHM-xx
- xx_RHMP-xx
- xx_RHMDP-xx

Metal TableTop Chain:

- xxS31xx up to xxS72xx
- xxM31xx up to xxM72xx
- xxx815-K2.25IN up to xxx815-K7.5IN
- xxx812-K2.25IN up to xxx812-K7.5IN

Rexnord set code number: 10143737

Metal TableTop Chain Heavy-Duty Hinge

Features a machined quality block made out of impact-resistant Polyamid Material for safe and easy operation; suitable for Heavy-Duty Single-Hinge Metal TableTop Chain executions.

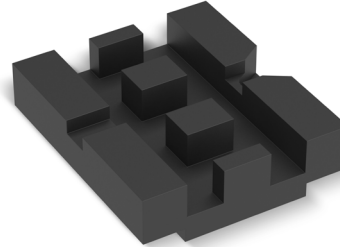

Suitable for the following chains:

Metal TableTop Chain:

- xxS75xx
- xxM75xx

Rexnord set code number: 10360631

Metal TableTop Chain 661 Series Chain

Features a machined quality block made out of impact-resistant Polyamid Material for safe and easy operation; suitable for Rexnord 661 series Metal TableTop Chain executions.

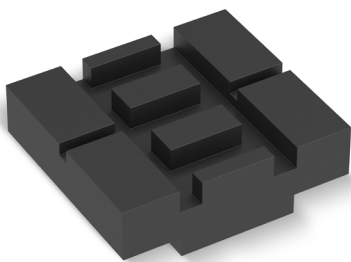

Suitable for the following chains:

Metal TableTop Chain:

- 661Sxxx
- 661Mxxx

Rexnord set code number: 10361105

Metal TableTop Chain Heavy-Duty Double-Hinge

Features a machined quality block made out of impact-resistant Polyamid Material for safe and easy operation; suitable for Double-Hinge Metal TableTop Chain executions.

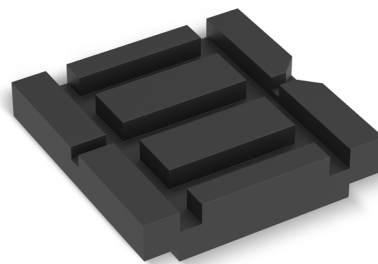

Suitable for the following chains:

Metal TableTop Chain:

- xxS77xx
- xxx802-4.5IN up to xxx802-7.5IN
- xxx800-7.5IN
- xxx805-7.5IN

Rexnord set code number: 10360579