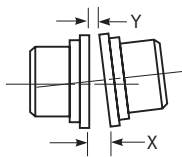
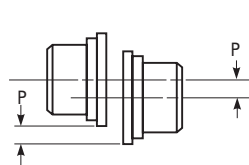
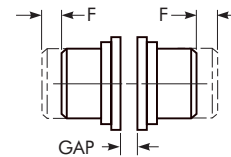

Supplement to Service Manuals 428-311 & 428-312

Follow the assembly instructions in Service Manuals 428-311 and 428-312 and the specifications tabulated below. Drawings in these manuals are representative of this series of couplings and do not agree in exact detail with each coupling size. However, the assembly procedure is basically the same for all sizes. To facilitate assembly of the larger covers (Step 6 of 428-311 and 428-312), use blocks to hold the lower half and lower it into position. Insert cover gaskets and then fasten the cover halves together. Insert lube plugs. Consult the Factory for limited end float kits.

Information herein for Sizes 1150 thru 1200 also applies to Sizes 150 thru 200 respectively, for example, 1150=150, 1200=200, etc. DO NOT use orange grids in place of blue grids. However, blue grids may be used in place of orange grids.

ANGULAR MISALIGNMENT

PARALLEL OFFSET MISALIGNMENT

END FLOAT

TABLE 1 — Installation & Alignment Data *

SIZE	Installation Limits ■				Operating Limits			Bolt Tightening Torque Values		Allow Speed (rpm)	Lube Wt (lb)
	Parallel Offset-P (in)	Angular (x-y) (in)	Hub Gap ± 10%		Parallel Offset-P (in)	Angular (x-y) (in)	End Float Physical Limit (Min) 2 x F (in)	Flange (lb-ft)	Cover (lb-ft)		
			T31	T35							
1150T	.012	.016	.375	.250	.024	.062	.620	250	54	1500	4.3
1160T	.012	.018	.375	.250	.024	.070	.640	250	54	1350	6.2
1170T	.012	.020	.375	.250	.024	.079	.617	250	108	1225	7.7
1180T	.015	.022	.375	.250	.030	.089	.717	740	108	1100	8.3
1190T	.015	.024	.375	.250	.030	.097	.620	1050	108	1050	9.7
1200T	.015	.027	.375	.250	.030	.107	.620	1050	192	900	12.4

* Refer to selection guide for maximum bores and Engineering manual 427-108 for re-boring instructions.

■ Flexible couplings are designed to accommodate changes in operating conditions. Coupling life expectancy between initial alignment and maximum operating limits is a function of load, speed and lubrication. Application requirements in excess of twice the OFFSET and/or four times the ANGULAR limits shown, must be referred to the Factory for review.