

Type T Grid Coupling Misalignment and End Float – Inches

Maximum life and minimum maintenance for the coupling and connected machinery will result if couplings are accurately aligned. Coupling life expectancy between initial alignment and maximum operating limits is a function of load, speed, and lubrication. Maximum operating values listed on Page 2 are based on catalogued allowable rpm.

Values listed in the table herein are based upon the use of the gaps listed, standard components, standard assemblies, and catalogued allowable speeds.

Values may be combined for an installation or operating

condition. Static limits are extremes and cannot be combined.

Note: For applications requiring greater misalignment, refer application details to the Factory.

Angular misalignment is the dimension X minus Y as illustrated below.

Parallel misalignment is the distance P between the hub center lines as illustrated below.

End float (with zero angular and parallel misalignment) is the axial movement of the hub(s) within the cover(s) measured from “0” gap.

ANGULAR MISALIGNMENT

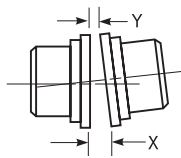

PARALLEL OFFSET MISALIGNMENT

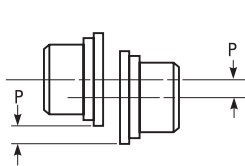

END FLOAT

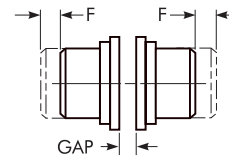
Table 1 Recommended Installation Maximum Values

SIZE	Parallel Offset-P			Angular	Normal Gap ± 10 %	
	Cover Types T10 T20	Type T50	Type T70	All Types (1/16°) X Minus Y	All Types Except T31	Type T31
1020T	.000003	.125	.188
1030T	.006	.002	.003	.003	.125	.188
1040T	.006003	.125	.188
1050T	.008	.002	.004	.004	.125	.188
1060T	.008005	.125	.188
1070T	.008	.002	.004	.005	.125	.188
1080T	.008	.002	.004	.006	.125	.188
1090T	.008	.003	.004	.007	.125	.188
1100T	.010	.003	.005	.008	.188	.250
1110T	.010	.003	.005	.009	.188	.250
1120T	.011	.003	.006	.010	.250	.375
1130T	.011	.004	.006	.012	.250	.375
1140T	.011	.004	.006	.013	.250	.375
1150T	.012	.004	.006	.016	.250	.375
1160T	.012	.005	.006	.018	.250	.375
1170T	.012	.005	.006	.020	.250	.375
1180T	.015	.005	.008	.022	.250	.375
1190T	.015	.006	.008	.024	.250	.375
1200T	.015	.006	.008	.027	.250	.375
1210T	.018029	.500	...
1220T	.018032	.500	...
1230T	.019035	.500	...
1240T	.019038	.500	...
1250T	.020042	.500	...
1260T	.020046	.500	...



Table 2 Maximum Operating Values

SIZE	Parallel Offset-P		Angular	End Float Physical Limit (Min.) 2 x F		
	Cover Types		All Types	Cover Types		Types
	T10 T20	Type T70	(1/4°) X Minus Y	T 10	T20	T50 T70
1020T	.012010	.210	.186	...
1030T	.012	.006	.012	.198	.186	.238
1040T	.012013	.211	.186	...
1050T	.016	.008	.016	.212	.186	.240
1060T	.016018	.258	.220	...
1070T	.016	.008	.020	.259	.220	.281
1080T	.016	.008	.024	.288	.282	.311
1090T	.016	.008	.028	.286	.282	.315
1100T	.020	.010	.033	.429	.408	.439
1110T	.020	.010	.036	.429	.408	.434
1120T	.022	.011	.040	.556	.546	.551
1130T	.022	.011	.047	.551	.548	.552
1140T	.022	.011	.053	.571	.568	.562
1150T	.024	.012	.062	.620	.620	.565
1160T	.024	.012	.070	.640	.630	.565
1170T	.024	.012	.079	.617	.630	.565
1180T	.030	.015	.089	.717565
1190T	.030	.015	.097	.620565
1200T	.030	.015	.107	.620565
1210T	.036118	1.020
1220T	.036129	1.150
1230T	.038142	1.120
1240T	.038154	1.120
1250T	.040169	1.120
1260T	.040183	1.010

Operating offset limits between type T50 floating shaft assembly is .0043" per inch of shaft separation.

Table 3 Static Limits

SIZE	Parallel Offset-P		Angular X Minus Y				
	Cover Types T10 T20	Type T70	Cover Type T10		Cover Type T20		Types T50 (3/4°) T70 (3/4°)
			Inches	Degrees	Inches	Degrees	Inches
	1020T	.04017	4.27	.12	3.07
1030T	.040	.012	.20	4.31	.14	2.97	.035
1040T	.04019	3.65	.15	2.88	...
1050T	.450	.016	.22	3.55	.15	2.45	.047
1060T	.45021	2.90	.16	2.28	...
1070T	.450	.016	.23	2.95	.17	2.17	.059
1080T	.050	.016	.21	2.14	.17	1.77	.073
1090T	.050	.016	.23	2.10	.18	1.66	.083
1100T	.060	.020	.37	2.84	.26	2.04	.098
1110T	.060	.020	.37	2.56	.28	1.94	.107
1120T	.070	.022	.37	2.27	.28	1.73	.121
1130T	.070	.022	.45	2.40	.32	1.69	.141
1140T	.070	.022	.50	2.33	.35	1.62	.160
1150T	.075	.024	.37	1.55	.35	1.42	.187
1160T	.075	.024	.45	1.61	.41	1.47	.211
1170T	.075	.024	.42	1.34	.44	1.40	.237
1180T	.090	.030	.50	1.40268
1190T	.090	.030	.50	1.29290
1200T	.090	.030	.50	1.16322
1210T	.11053	1.12
1220T	.11050	0.98
1230T	.11550	0.88
1240T	.11563	1.02
1250T	.14078	1.16
1260T	.14075	1.03