

SIZES 315 THRU 507 AND 2315 THRU 2507 (Sizes 600 & 608 on Page 2)

Shims and gaskets are available in kit form only; order by "Kit Number." Use reference and part numbers for identifying parts when received. Disregard extra parts; this is a multipurpose kit.

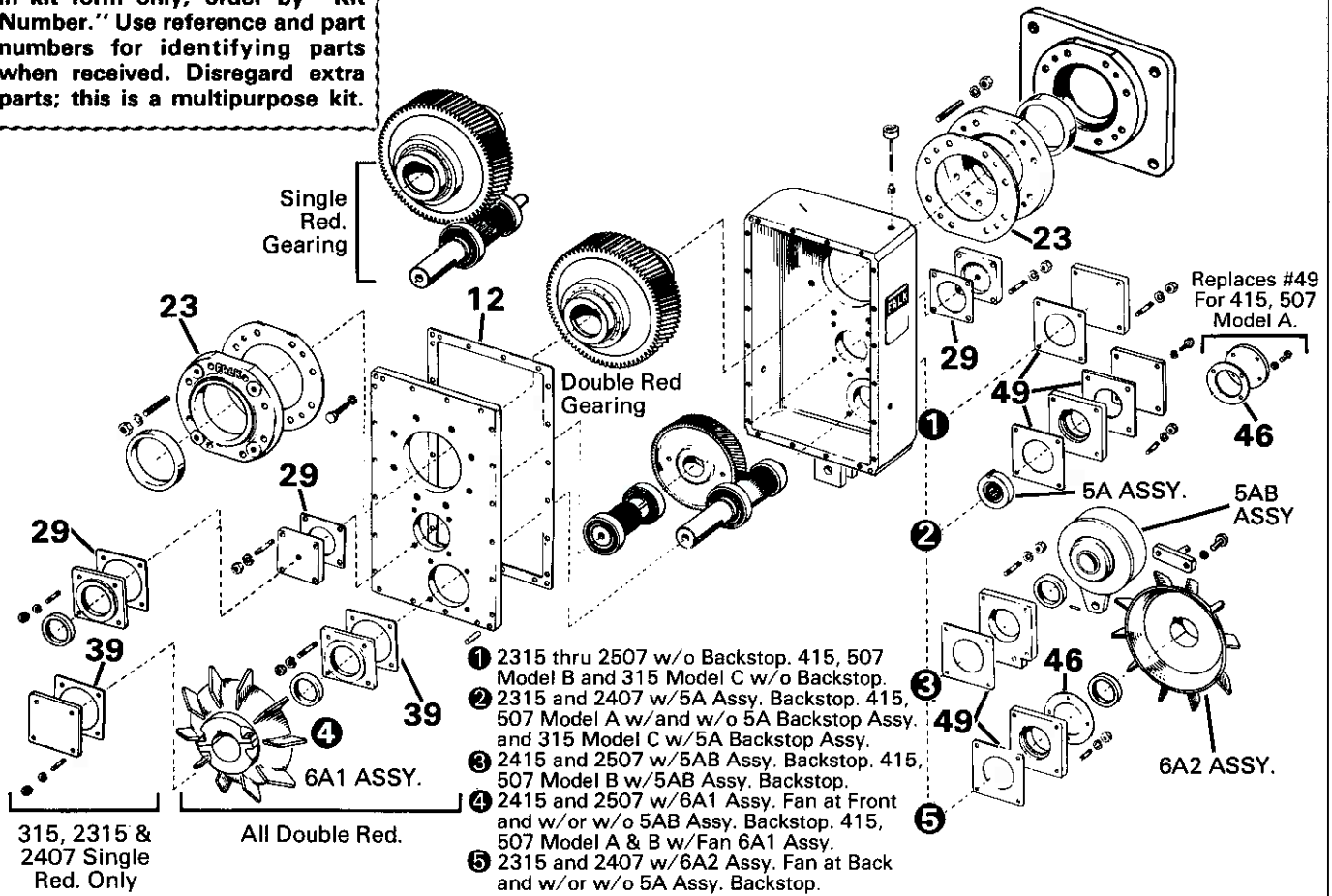

SHIM-GASKET PART NUMBERS

Ref. No.	Shim-Gasket Positions	Shim Thickness (in.)	UNIT SIZE			
			2315 and 315	2407		2415 2507, 415 & 507
				Single	Double	
100	Complete Kit	728297	736426	728298	706021
12	Housing Base & Cover	.062	331033	334658	334658	413520
23	Low Speed Seal Cage	.007	288889	288889	288889	240272
		.009	712481	712481	712481	704693
		.015	712482	712482	712482	704694
		.031	723422	723422	723422
29	Intermediate End Cover and Cage	.007	1202247	1211273	1202330	187665
		.009	713483	743980	723463	704685
		.015	713484	743981	723464	704686
		.031	713485	743982	723465
39	H.S. Cage & Cover	.007	187666
		.009	704687
		.015	288890	1202323	1202323	704688
46	End Cover Fan or Backstop	.015*	1202991	1202991	187667
49	H.S. Cage & Cover	.015	713484	713484	713484	704688

* For Sizes 2415, 2507, 415 and 507 shim thickness is .031".

Always position one (1) .015" thick shim-gasket next to the bolted on member . . . end cover, seal cage, etc. to seal unit. Use shim-gaskets as instructed in the service manual to adjust bearings.

SIZES 600 AND 608

Shims and gaskets are available in kit form only; order by "Kit Number." Use reference and part numbers for identifying parts when received. Disregard extra parts; this is a multipurpose kit.

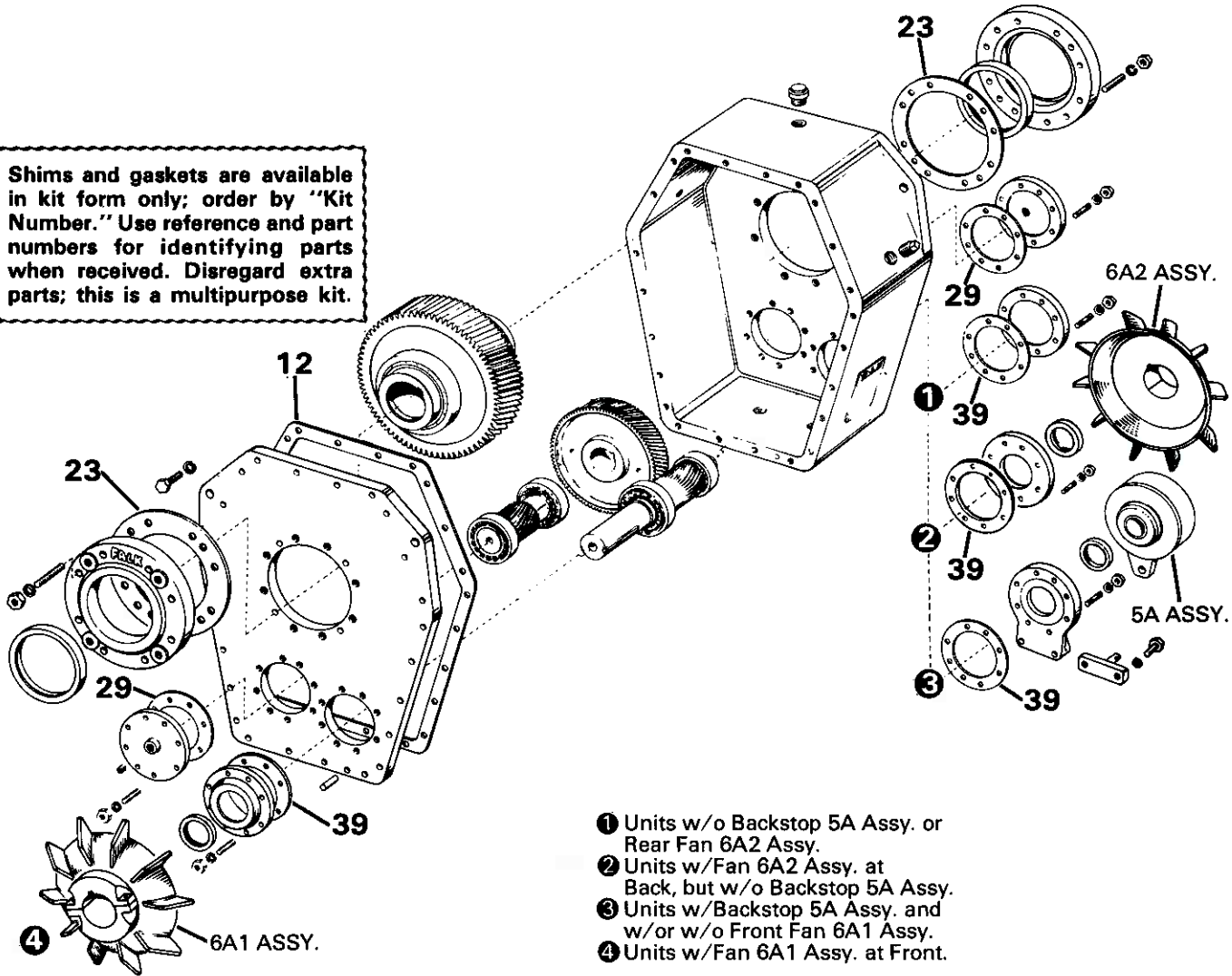

SHIM-GASKET PART NUMBERS

Ref. No.	Shim-Gasket Positions	Shim Thickness (in.)	UNIT SIZE	
			600	608
100	Complete Kit	712842	712843
12	Housing Base & Cover	.062	329848	329946
23	Low Speed Seal Cage	.007	284674	284674
		.009	710706	710706
		.015	710707	710707
29	Intermediate End Cover	.007	1130519	1130519
		.009	710704	710704
		.015	710705	710705
39	High Speed Cages	.007	1130518	1130518
		.009	710702	710702
		.015	710703	710703

Always position one (1) .015" thick shim-gasket next to the bolted on member . . . end cover, seal cage, etc. to seal unit. Use shim-gaskets as instructed in the service manuals to adjust bearings.