

Introduction

This parts guide is designed to assist in ordering replacements parts for standard Type "EZ" and "C" double reduction Motoreducers and Speed Reducers, Sizes 1 and 15. Consult Falk for Type "EF," "EZ," "EFX" and special or modified drives.

- IDENTIFY drive — Record Drive Model, Ratio and M.O. Number from nameplate.

Sample Nameplate

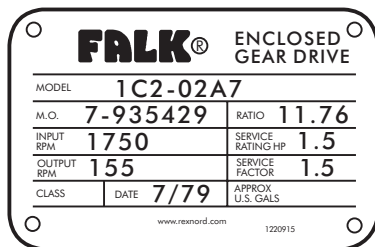

Gear Drive Identification

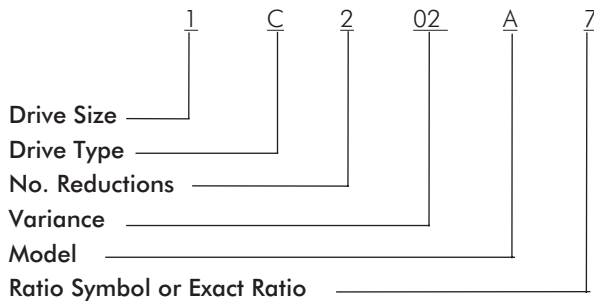

Variations

The primary variations for these drives are low speed helical gear width (wide or narrow) and drives with backstops.

- IDENTIFY INDIVIDUAL PARTS — Use exploded view on Page 2 to determine Ref. No. of required parts.

| Ref. No. | Part Description |
|----------|------------------|
| 1A2-1 | Bearing |
| 1A2-2 | Bearing |
| 1A2-3 | Shaft |
| 1A2-4 | Pinion |
| 1A2-5 | Spacer |

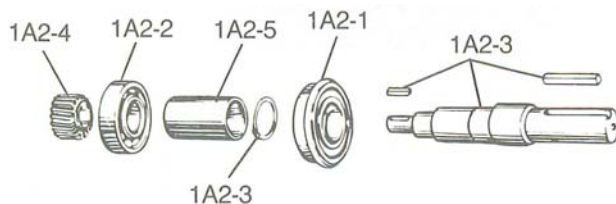

NOTE: Replace seals, shims, and gaskets whenever reassembling a reducer. Shim-gaskets and fasteners are available only in kits as shown below.

SHIMS & GASKETS — See Kit Ref 105
FASTENERS — See Kit Ref 111

Corrosion Protection & Storage

CAUTION: Follow guidelines below to avoid damage to parts.

- For domestic or indoor storage, Factory provides standard 24 month protection as boxed or optional 24 month protection for individual parts.
- For export or outdoor storage, Factory provides optional 18 month protection.

CAUTION: This protection does not cover exposure to elements such as standing water, etc.

| Ref. No. | Description |
|-------------|---|
| 4 | Seal Cage, Replace with Ref 114 |
| 4B | Seal |
| 29 | Seal Cage, Replace with Ref 129 |
| 29A | Seal |
| 84 | Head |
| 89 | Vent Plug |
| 105 | Shim Gasket Kit, Incls Ref 5, 30 & 82 |
| 111 | Fastener Kit, Incls Ref 6, 11, 28 & 31 |
| 114 | Seal Cage Assembly, Incls Ref 4, 4B & 5 |
| 129 | Seal Cage Assembly, Incls Ref 29, 29A & 30 |
| 1A2 | Shaft Assembly, Incls Ref 1A2-1 thru 1A2-5 |
| 1A2-1 | Bearing |
| 1A2-2 | Bearing |
| 1A2-3 | Shaft |
| 1A2-4 | Pinion |
| 1A2-5 | Spacer |
| 1A52 | Shaft Assembly, Incls Ref 1A52-30 Backstop |
| 1A52-2 | Bearing |
| 1A52-4 | Pinion |
| 1A52-19 | Sprag & Spring Kit |
| 1A52-30 | Backstop Sub-Assembly, Incls Ref 1A52-19 |
| 4A | Shaft Assembly, Incls Ref 4A-1 thru 4A-5 |
| 4A-1 | Bearing |
| 4A-2 | Bearing |
| 4A-3 | Pinion & Shaft |
| 4A-4 | Gear |
| 4A-5 | Locknut |
| 5A | Shaft Assembly, Incls Ref 5A-1 thru 5A-12 |
| 5A-1 | Bearing |
| 5A-2 | Bearing |
| 5A-3 | Shaft |
| 5A-4 | Gear |
| 5A-4A | Spacer |
| 5A-11 | Locknut |
| 5A-12 | Oil Ring |

