

## Introduction

This parts guide is designed to assist in ordering replacements parts for standard gear drives. Consult Factory for special or modified drives.

- 1. IDENTIFY DRIVE** — Record Drive Model, Ratio and M.O. Number from nameplate.

### Sample Nameplate

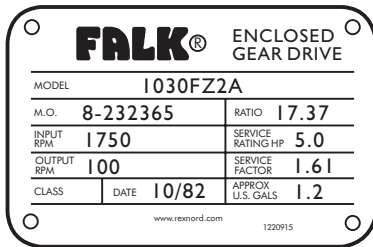

### Gear Drive Identification

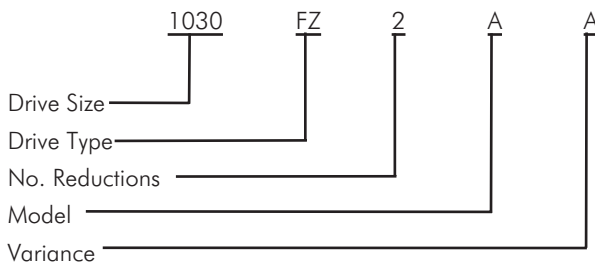

### Variance Definitions:

Blank = Standard Drive

A = Drive equipped With Backstop

S = Special — Refer to Factory

- 2. IDENTIFY INDIVIDUAL PARTS** — Use exploded view on Page 2 to determine Ref. No. of required parts.

#### 1A ASSEMBLY

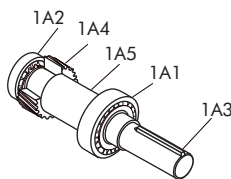

Ref. No.	Part Description
1A1	Bearing
1A2	Bearing
1A3	Shaft
1A4	Pinion
1A5	Spacer

**NOTE:** Replace seals, shims, and gaskets whenever reassembling a drive. Shim-gaskets and fasteners are available only in kits as shown below.

SHIMS & GASKETS — See Kit Ref. No. 100

FASTENERS — See Kit Ref. No. 130

## Corrosion Protection and Storage

**CAUTION:** Follow guidelines below to avoid damage to parts.

- For domestic or indoor storage, Factory provides standard 24 month protection as boxed or optional 24 month protection for individual parts.
- For export or outdoor storage, Factory provides optional 18 month protection.

**CAUTION:** This protection does not cover exposure to elements such as standing water, etc.

Ref. No.	Part Description
14	Seal
15	Seal
20	Dipstick
21	Seal Cage (Replace with Ref 121)
22	Seal Cage (Replace with Ref 122)
28	Shaft Cover
29	Shaft Cover (Replace with Ref 129)
32	Shaft Cover (Replace with Ref 132)
33	Backstop Cage
34	Backstop
100	Shim-Gasket Kit (Incls Ref 87, 89, 91, 94)
101	Housing Assembly (Incls Ref 110, 113, 114, 100, 130, 20)
120	Backstop Assembly (Incls Ref 32, 33, 34, 68, 91)
121	Seal Cage Assembly (Incls Ref 14, 21, 87)
122	Seal Cage Assembly (Incls Ref 15, 22, 89)
129	Shaft Cover Kit (Incls Ref 29, 91)
130	Fastener Kit (Incls Ref 59, 60, 66, 68, 73)
132	Shaft Cover Kit (Incls Ref 32, 91)
<b>1A Shaft Assembly — Incls Ref 1A1 thru 1A5</b>	
1A1	Bearing
1A2	Bearing
1A3	Shaft
1A4	Pinion
1A5	Spacer (Sizes 1050/50 Only)
<b>4A Shaft Assembly — Incls Ref 4A1 thru 4A7</b>	
4A1	Bearing
4A2	Bearing
4A4	Pinion & Shaft (Incls Ref 4A7)
4A6	Gear
4A7	Locknut
<b>5A Shaft Assembly — Incls Ref 5A1 thru 5A6</b>	
5A1	Bearing
5A2	Bearing
5A6	Gear & Shaft

**TABLE 1 — 1A Shaft Assembly <sup>1</sup>**

Ratio	Drive Size				Ratio
	1020/20	1030/30	1040/40	1050/50	
1.50 thru 17.09	1A3 & 1A4			50 Model M & 1050 Only	1.50 thru 17.09
20.93					20.93
25.63					25.63
31.39					31.39

<sup>1</sup> Individual components for Drive Sizes and Ratios shown in the SCREENED area may be ordered separately. High interference fit components which must be assembled at the Factory are identified in the table above.

## Parts Diagram

